

NRSBU Wastewater Pipe Duplication Project



3 July to mid December

The wastewater pipe along Elms Street is being upgraded. Ching Contracting Ltd is the contractor appointed to complete the work, and will be liaising with businesses in the area before work gets underway. This work will have an impact on traffic.

Why are we upgrading services?

This project will improve the resilience of the sewer network. A secondary sewer main is being installed around the Waimea inlet from the Beach Road pump station in Richmond to Monaco.

Upcoming works

The proposed work area is on Kotua Place and Elms Street.

Ching Contracting Ltd will be starting the initial works on 3 July 2023. Works are expected to last for 6 months. The first stage of the work at Kotua Place will last for eight weeks.

There will not be any detours; however, there will be some traffic flow restrictions, as you can view from the map below.

- The proposed work areas will be a combination of coned 2-way traffic flows, lane closures where traffic will be restricted to a single lane with priority give way or stop/go traffic control where required
- A speed restriction of 30km/hr in the proposed work zone.
- Traffic restrictions will only be in place in the marked areas below when the contractor is working on that stage of the works.

All businesses are open

Throughout this project all businesses are open and accessible. Signage will be in place to show drivers where to go to reach Elms Street and Kotua Place.

Contact:

- Sarah Boulton (Ching Contracting Ltd)
021 547 692, 03 547 0755 or
sarah@chings.co.nz
- Deepak Martin (NCC Project Manager)
03 546 0200 or deepak.martin@ncc.govt.nz

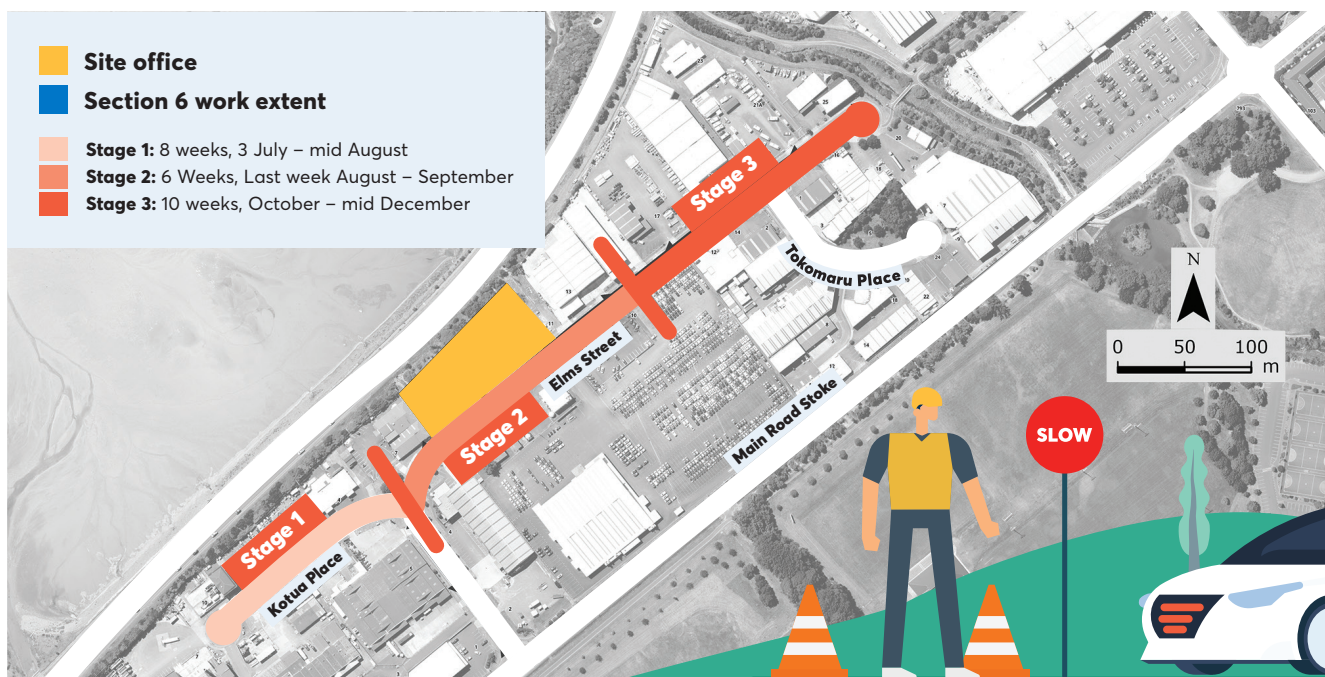

Nelson
City Council

Te Kaunihera o
Whakatū